

ACHTERGEVEL

ZUID-OOSTGE

- $K = 21 \text{ m}^2$
- $L = 22 \text{ m}^2$
- $M = 22,5 \text{ m}^2$
- $N = 22,5 \text{ m}^2$
- $O = 20,5 \text{ m}^2$

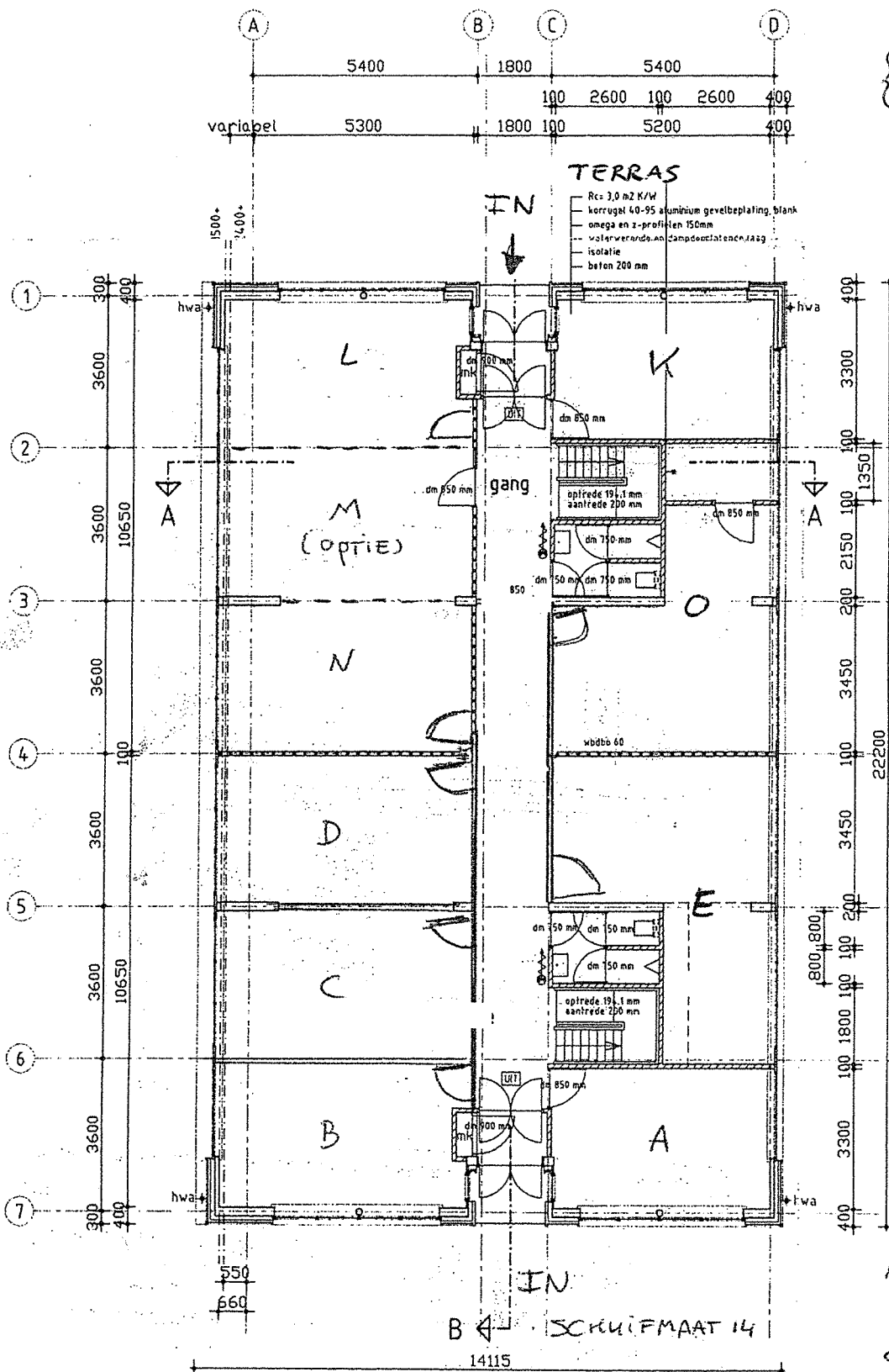

TERRAS
 IN
 Rc = 3,0 m²/K/W
 korrugeel 40-95 aluminium gevelbeplating, blank
 omega en z-profielen 150mm
 vslafveranda en dampdoortatene, raag
 isolatie
 beton 200 mm

SCHUIFMAAT 14

IN
SCHUIFMAAT 14

BEGANE GROND

- $A = 21 \text{ m}^2$
- $B = 22 \text{ m}^2$
- $C = 22,5 \text{ m}^2$
- $D = 22,5 \text{ m}^2$
- $E = 20,5 \text{ m}^2$